

# 4K 20X Black light illumination Network PTZ Camera

305-D20X 4K

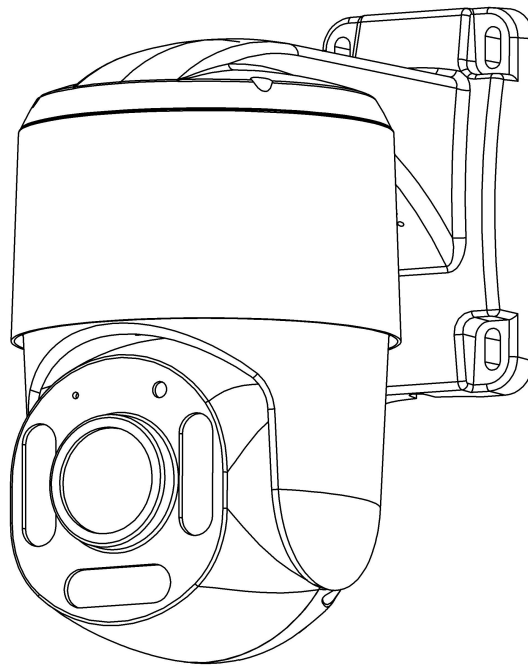

## Key Features

Supporting Face detection, Humanoid detection

8.0MP HD Black light illumination resolution, clear and fine images

Support 2D/3D noise reduction, digital wide dynamic

Advanced H.265A1/H.265+(Compatible with H.265/H.264) video compression, Super low rate, high definition quality of image

Works with mainstream 3rd party NVR/Client such as Blue Iris, Security Spy, Milestone, Geovision, Synology and QNAP

Support cloud technology, easy to achieve network penetration, fo in-line and alarm information pushed

## Specifications

Parameters	Description
Sensor	8.0M Black light illumination CMOS sensor
Min. Illumination	color 0.0001Lux@F1.2, black/white 0.0001Lux@F1.2
Day/Night	IR-cut filter with auto switch (ICR)
Video compression	H.265A/H.265+(Compatible with H.265/H.264), support dual stream, AVI; 0. 1M~8Mbps variable; 1~30f/s variable
Image output	Main stream: 8MP 3840*2160@15fps; 5MP 2880*1616@25fps; 4MP 2560*1440@25fps; 2MP 1920*1080@25fps sub-stream: 800*448@25fps
Shutter	1/50(1/60) s to 1/ 10,000s
Noise reduction	Support 2D/3D
Wide dynamic	Support digital
Lens type	4.7 ~ 94mm, AF automatic focusing and motorized zoom lens
Optical Zoom	20
IR Range	Up to 100m (328ft)
Wavelength	850nm
Warm Light Range	Up to 20m (66ft)
IR On/Off Control	Auto/Manual
Audio compression	G.711, support bidirectional talk, audio&video synchronization
Two-way Audio	Built-in
Image Flip	Normal/Flip Vertical/Flip Horizontal/180°
Intelligence analysis	Supporting Face detection, Humanoid detection, and supports customization of other smart functions etc.
Auto Tracking	Support
Edge Storage	Micro SD, up to 256 GB
Network Storage	Support
Protocols	RTSP/FTP/DHCP/NTP/UPnP etc
Compatible Integration	ONVIF, API,SDK
Mobile monitoring	Support multiple mobile monitoring (iOS , Android)
Other function	Support WEB, OSD, live video transmission, motion detect, front-end storage/playback/download, and center reminder and image linkage, support JPEG capture, united remote client monitoring software
Pan Range	355°
Pan Speed	0.1°/s ~ 20°/s, Preset speed: 20°/s
Tilt Range	-5° ~ 90°
Tilt Speed	0.1°/s ~ 20°/s, Preset speed: 20°/s
Presets	Support
Preset Patrol	Support
Home Position	Support
Network	1 × RJ45 10/100M adaptive Ethernet port
Power	DC12V, PoE+(IEEE 802.3at)
Power Consumption	Max. 18W
Dimensions	∅136 mm × 223mm (∅5.35" × 8.78") (∅ × H)
Weight	1.15kg (2.54lb)
Working Environment	-20°C to 60°C (-4°F to 140°F), Humidity: ≤ 95% RH (non-condensing)
Surge Protection	4 KV
Ingress protection	IP66
Case Type	PT(Aluminium/Plastic)

Dimensions (mm)

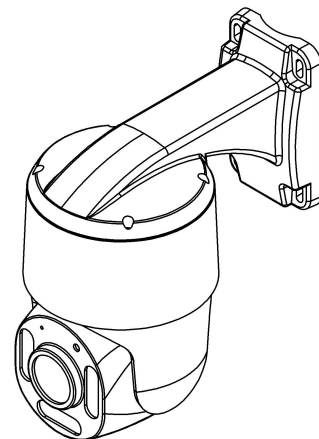
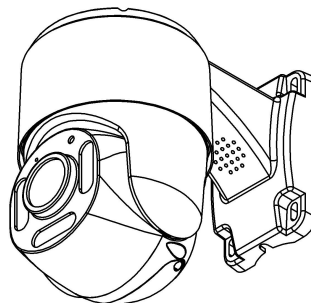
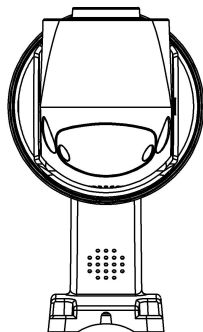
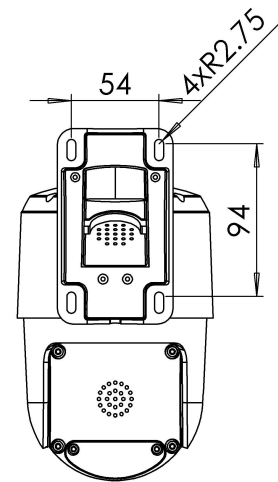
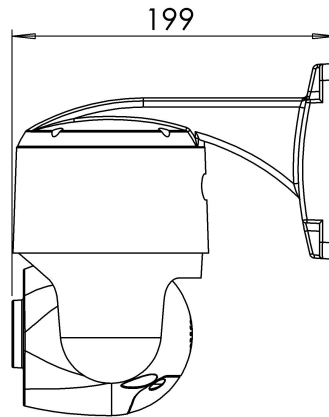
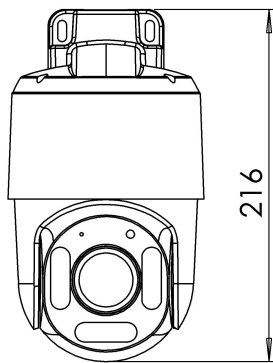
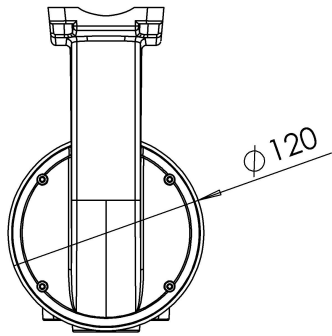

Hangzhou Sunba Technologies Co., Ltd.

 <http://www.sunbatech.com>

 [support@sunbatech.com](mailto:support@sunbatech.com); [support@sunba.net](mailto:support@sunba.net)

©2022-2025 Hangzhou Sunba Technologies Co., Ltd. All rights reserved.

\*Product specifications and availability are subject to change without notice.

\*Despite our best efforts, technical or typographical errors may exist in this document.

Sunba cannot be held responsible for any such errors and reserves the right to change the contents of this document without prior notice.

